

WEATHERPROOF HORN Loudspeakers



➤ **PH30/T**
➤ **PH30/TC**

TECHNICAL SPECIFICATIONS

Rated power, Watts	30
Tappings 100 volt line, Watts	30/15/7.5/3.75
Transformer Impedance, Ohms, 100V	330/660/1.32k/2.64k
Tappings 70.7 volt line, Watts	15/7.5/3.75/1.875
Driver impedance, Ohms	20
Effective frequency range, Hz (BSEN60268-5)	330-8,000
S.P.L. @ 1m, 1 watt, dB, Test Signal Bandwidth 100Hz-10 kHz	103
S.P.L. @ Full power Octave Bandwidth, dB	118
Acoustic Power (dB-PWL@1 watt) 1 kHz, dB	101/100
Dispersion at 1k/2kHz, Degrees	110/70
Directivity Axial Q factor, 1 k/2kHz	6.20/15.1
IP Rating	66
Max/Min Ambient Temp	70°/-25°
Dimensions, front & depth, mm	Ø 238 x 287
Net weight, Kgs	2.30
Colour/Finish	Grey RAL7035
Material	ABS plastic housing with UV inhibitors
Mounting	Stainless Steel U Bracket

- PH30/TC is BS5839 Part 8 Voice Alarm compliant but not EN54-24 Certified.
- PH30/T is not supplied with a cable tail.
- Suitable for external use

February 2017

PH30/T PH30/TC

WEATHERPROOF HORN LOUSPEAKERS

side view

unit: mm

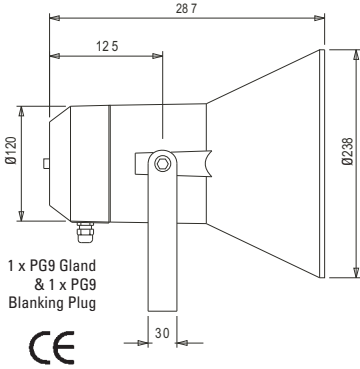

front view

unit: mm

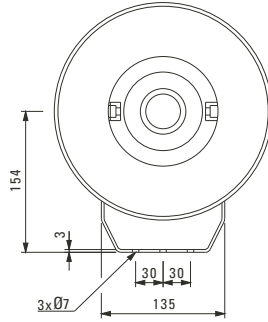

circuit diagram

PH30/T

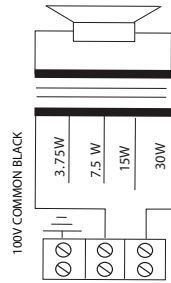

speech octave band sensitivity

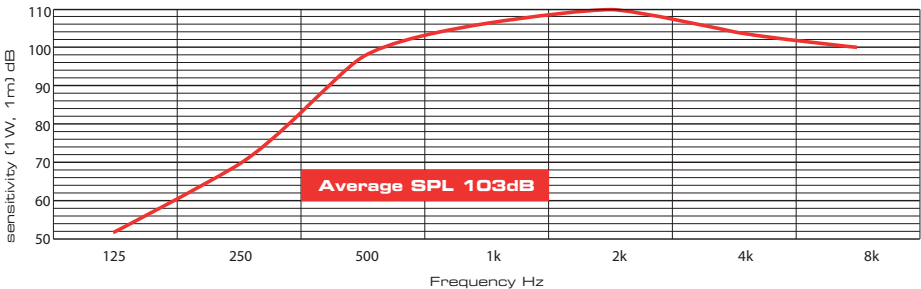

Effective Frequency Range • PH30/T PH30/TC 330Hz - 8,000Hz



Penton UK Ltd

Unit 2 Teville Industrials | Dominion Way | Worthing | West Sussex | BN14 8NW
 T: +44 (0)1903 215315 | F: +44(0)1903 215415 | E: SALES@PENTONUK.CO.UK

www.pentonuk.co.uk